

RE140 (3 POLE) & RE140/1 DC MOTOR

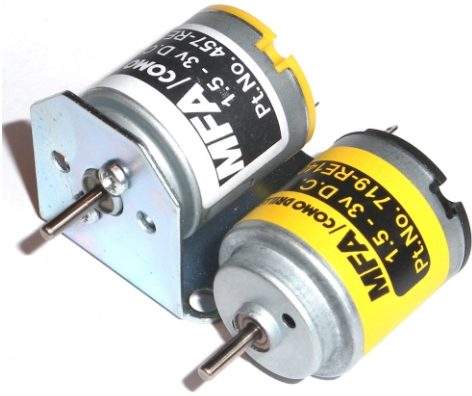

- Part No: 457RE140 (MOTOR WITH BRACKET)
- Part No: 719RE140 (MOTOR WITHOUT BRACKET)
- Part No: 457RE140/1 (MOTOR WITH BRACKET)
- Part No: 719RE140/1 (MOTOR WITHOUT BRACKET)
- Part No: 724 MOTOR BRACKET (90° ONLY)

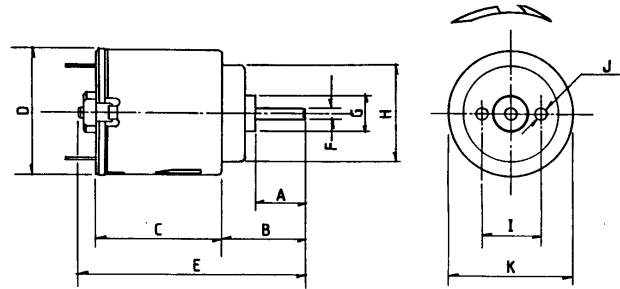

Weight: 20g (approx)

DIMENSIONS	A	B	C	D	E	F	G	H	I	J	K
Millimeter	8.3	14.0	21.0	21.0	38.0	2.0	6.15	16.0	10.0	2.0	20.15
Decimal Inches	0.33	0.55	0.827	0.827	1.496	0.079	0.242	0.63	0.394	0.079	0.793

MOTOR DATA. (RE140 & RE140/1)

MODEL	VOLTAGE		NO LOAD		AT MAXIMUM EFFICIENCY						STALL TORQUE	
	OPERATING RANGE	NOMINAL	SPEED	CURRENT	SPEED	CURRENT	TORQUE		OUTPUT	EFF	TORQUE	
			R.P.M.	A	R.P.M.	A	oz-in	g-cm	W	%	oz-in	g-cm
RE140	1.5 - 3	1.5v Constant	8200	0.190	6250	0.62	0.089	6.4	0.400	44.2	0.375	27.0
RE140	1.5 - 3	3v Constant	15300	0.26	12200	1.04	1.444	13	2.51	52.3	0.750	64.0
RE140/1	3 - 9	6v Constant	9200	0.066	7071	0.219	0.11	8.1	0.589	44.79	0.48	35.1

Stall Current: RE140 at 1.5v = 1.6A RE140 at 3v 3.0A, RE140/1 at 6v 0.7A