

**RE-385LN (5 POLE). NOISE ATTENUATED**

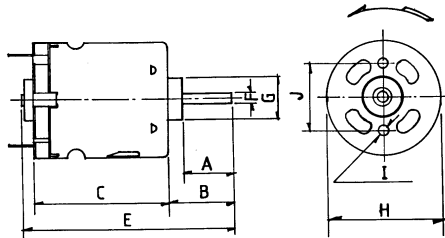

Part No. 457RE-385LN (WITH BRACKET)  
 Part No. 719RE-385LN (WITHOUT BRACKET)  
 Part No. 725 MOTOR BRACKET (90° ONLY)



**Weight 110g (approx)**

DIMENSIONS	A	B	C	E	F	G	H	I	J
Millimeter	6	8.5	46.5	57.3	2.3	10.0	29.	M3	16.0

MODEL	VOLTAGE		NO LOAD		AT MAXIMUM EFFICIENCY					STALL TORQUE		
	OPERATING RANGE	NOMINAL	SPEED R.P.M.	CURRENT A	SPEED R.P.M.	CURRENT A	TORQUE oz-in	TORQUE g-cm	OUTPUT W	EFF %	oz-in	g-cm
RE-385LN	6 - 12	12v Constant	7300	0.15	5950	0.9		110	6.72	62		660

Stall Current RE-385LN at 12v = 5.0A